

ISO 9001:2008 by L.R.
PED DIR. 97/23/EC by L.R.
ATEX DIR. 94/9/EC by B.V.
FIRE SAFE EXECUTION by L.R.
ISO 15848 by TÜV
ANTISTATIC DEVICE by L.R.
FIRE SAFE TESTED ISO 10497 by L.R.

TYPE
FU4
PN 10 ÷ 40
ANSI 150

NORME E DIRETTIVE APPLICATE DISPONIBILI AL SEGUENTE LINK:
STANDARD AND DIRECTIVE APPLIED AVAILABLE AT FOLLOWING LINK:
http://www.adlerspa.com/pdf/NORME_ADLER.pdf

VALVOLE A SFERA "3 VIE CORPO PIATTO" PASSAGGIO TOTALE 120°

ISO nbr° LRC 0160281 QMS issued by L.R.Q.A. PED nbr° COV 0212112/01 issued by L.R.V.
ATEX nbr° 40.2003.4392 issued by B.V. ISO 15848 nbr° I-148466/1-/2 issued by TÜV

On request
S.I.L. 3
According to IEC 61508

FULL BORE ACCORDING
TO ISO 14313

On request
FIRE SAFE
According to ISO 10497
"ISO-FT"

BREVETTO - PATENTED
00219616

CONSTRUCTION IN ACCORDING TO:
ANSI B16.34 - BS EN 12516-2

BALL VALVES "3 WAY WAFER" FULL BORE 120°
ROBINETS A BOISSEAU SPHERIQUE
"3 VOIES WAFER" PASSAGE INTEGRAL 120°
KUGELHÄHNE "3 WEGE KOMPAKTHAHN"
VOLLER DURCHGANG 120°

WEB SITE: WWW.ADLERSPA.COM

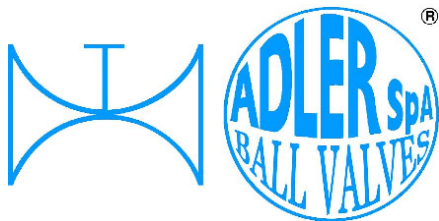

ISO 9001:2008 by L.R.
PED DIR. 97/23/EC by L.R.
ATEX DIR. 94/9/EC by B.V.
FIRE SAFE EXECUTION by L.R.
ISO 15848 by TÜV
ANTISTATIC DEVICE by L.R.
FIRE SAFE TESTED ISO 10497 by L.R.

TYPE
FU4
PN 10 ÷ 40
ANSI 150

VALVOLA A SFERA "3 VIE CORPO PIATTO" PASSAGGIO TOTALE 120°
BALL VALVES "3 WAY WAFER" FULL BORE 120°
ROBINETS A BOISSEAU SPHERIQUE "3 VOIES WAFER" PASSAGE INTEGRAL 120°
KUGELHÄHNE "3 WEGE KOMPAKTHAHN" VOLLER DURCHGANG 120°

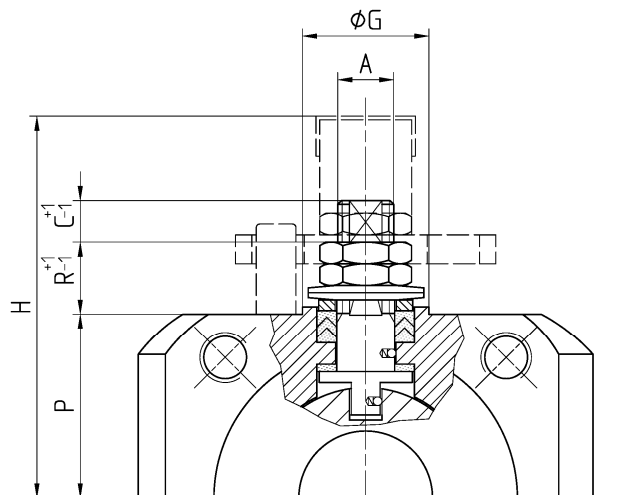

BREVETTO – PATENTED
00219616

DN 150 ÷ 200
-CONSIGLIATO
RIDUTTORE MANUALE
-MANUAL GEAR BOX
SUGGESTED
-REDUCTEUR MANUEL
CONSEILLE
-EMPFEHLEN WIR EIN
HANDGETRIEBE

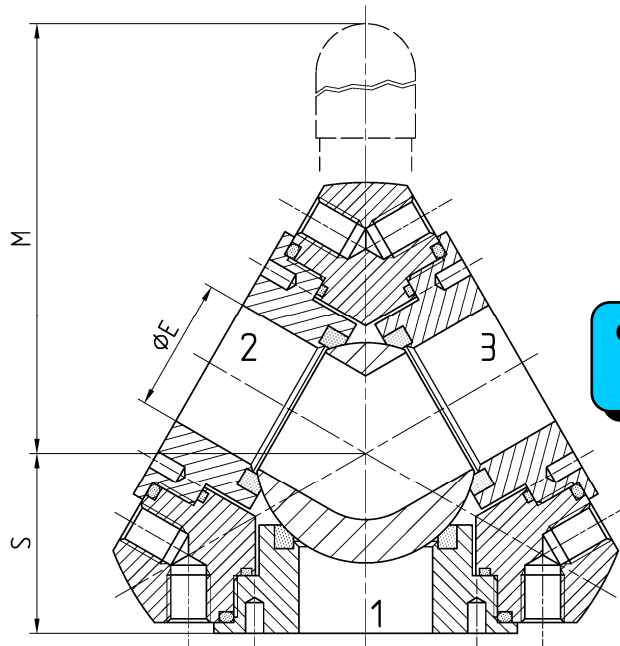

CONSTRUCTION IN ACCORDING TO:
ANSI B16.34 - BS EN 12516-2

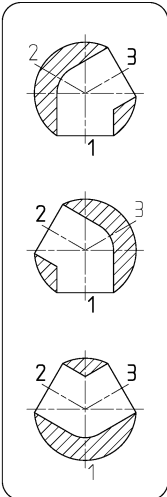

POSIZIONI OTTENIBILI
OBTAINABLE POSITIONS
POSITIONS OBTENABLES
MÖGLICHE STELLUNGEN

• ACCOPPIAMENTO VALVOLA
ATTUATORE
• CONNECTION VALVE
ACTUATOR
• ACCOUPLEMENT ROBINET-
ACTIONNEUR
• ZUSAMMENBAU KUGELHAHN
ANTRIEB
ISO-5211

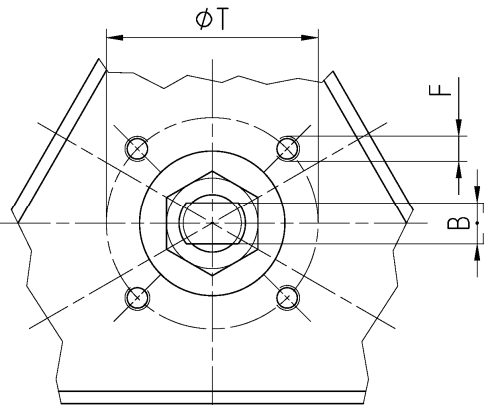

N.	DESCRIZIONE DESCRIPTION BESCHREIBUNG	MATERIALI MATERIALS MATERIAUX WERKSTOFFE
1	CORPO BODY CORPS KÖRPER	ASTM A105 ASTM A 182 F316- A479 S31600 ASTM A351 CF8M
2	GHIERA INSERT EMBOUT GEWINDED RUCKRING	ASTM A105 ASTM A 182 F316- A479 S31600 ASTM A351 CF8M
3*	O-RING	FKM - (VITON)
4*	ANELLO SEAL ANNEAU DICHTUNGSRING	P.T.F.E.
5*	SEDE SEAT SIEGE SITZRING	P.T.F.E. / R.P.T.F.E. (OPTIONAL)
6	SFERA BALL BOULE KUGEL	ASTM A182 F304-A479 S30400 ASTM A351 CF8 ≥ DN 40 ASTM A182 F316-A479 S31600 ASTM A351 CF8M
7	DISPOSITIVO ANTISTATICO ANTISTATIC DEVICE CONTACT ANTISTATIQUE ANTISTATIK VORRICHTUNG	ASTM A479 S31600
8	STELO STEM TIGE SPINDEL	ASTM A182 F304 A479 S30400 ≥ DN 40 ASTM A182 F316 A479 S31600

N.	DESCRIZIONE DESCRIPTION BESCHREIBUNG	MATERIALI MATERIALS MATERIAUX WERKSTOFFE
9*	BUSSOLA STEM SEAL JOINT TIGE UNTERE SPINDELABDICHTUNG	P.T.F.E.
10*	PACCO A "V" CHEVRON RINGS JOINT A "V" 3 FACHE DACHMANSCHETTE	P.T.F.E. / GRAFITE P.T.F.E. / GRAPHITE P.T.F.E. / GRAPHITE P.T.F.E. / GRAPHIT
11	PREMIBUSSOLA PRESSING BUSH PRESSE RONDELLE STOPFBUCHSDRUCKRING	ASTM A479 S31600
12	MOLLE A TAZZA SPRING WASHERS RONDELLES BELLEVILLE TELLERFEDERN	C72/50Cr V4 X5CrNi17.7 or X12CrNi17.7 ON REQUEST
13	VITE DI FERMO E FERMO PIN AND STOP PIN PLOT ET PLOT D'ARRET ANSCHLAGBOLZEN	UNI 3740 8.8 UNI 3951 A2-70 ON REQUEST
14	UNI 3740 - 6S ASTM A479 304	ZINCATO - GALVANIZED - ZINGUE - VERZINKT ON REQUEST
15	LEVA WRENCH LEVIER HANDHEBEL	UNI 5946 Fe 37 ASTM A479 304 ON REQUEST
16		

* RICAMBI CONSIGLIATI - RECOMMENDED SPARE PARTS - PIECES DE RECHANGE CONSEILLEES - ERSATZTEIL EMPFEHLUNG

DIMENSIONI - DIMENSION - DIMENSIONS - ABMESSUNGEN

DN	10	15	20	25	32	40	50	65	80	100	125	150	200	250	300
A	10	10	10	12	12	16	16	22	22	30	30	42	48		
B	6	6	6	8	8	10	10	14	14	18	18	28	32		
C	8	8	8	10	10	10	10	12	12	17	17	19	20		
E	15	15	19	25	30	38	51	64	76	101	118	152	203		
F	M5	M5	M5	M5	M5	M6	M6	M8	M8	M10	M10	M12	M16		
ISO	F03	F03	F03	F03	F03	F05	F05	F07	F07	F10	F10	F12	F14		
G	25	25	25	25	25	35	35	55	55	70	70	85	100		
H	66	66	66	85	90	109	119	143	152	172	185	253	295		
M	145	145	145	185	185	280	280	370	370	470	650	750	900		
P	32,5	32,5	35	41	46,5	55	65	82	90,5	99,5	113	144	183		
R	7	7	7	17	17	20	20	23	23	26	26	34	36		
S	33	33	36	39,5	45	46,5	51	56,5	66	77,5	91	137	155		
T	36	36	36	36	36	50	50	70	70	102	102	125	140		
~Kg	3,8	3,8	5	5,8	9	13	19	27	35	38	41	100	140		

- DATI E CARATTERISTICHE SOGGETTI A VARIAZIONI SENZA PREAVVISO
- SPECIFICATIONS SUBJECT TO MODIFICATION WITHOUT PRIOR NOTICE
- TOUS DROITS DE MODIFICATION RESERVES
- KONSTRUKTIONÄNDERUNGEN VORBEHALTEN

PN 10 ÷ 40 - ANSI 150

PN 10 ÷ 16



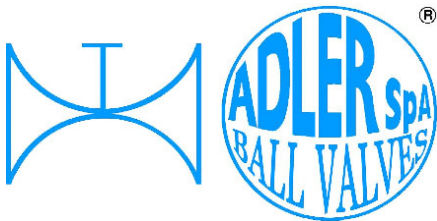

ISO 9001:2008 by L.R.
 PED DIR. 97/23/EC by L.R.
 ATEX DIR. 94/9/EC by B.V.
 FIRE SAFE EXECUTION by L.R.
 ISO 15848 by TÜV
 ANTISTATIC DEVICE by L.R.
 FIRE SAFE TESTED ISO 10497 by L.R.

TYPE
FU4
 PN 10 ÷ 40
 ANSI 150

VALVOLA A SFERA "3 VIE CORPO PIATTO" PASSAGGIO TOTALE 120°
 BALL VALVES "3 WAY WAFER" FULL BORE 120°

ROBINETS A BOISSEAU SPHERIQUE "3 VOIES WAFER" PASSAGE INTEGRAL 120°
 KUGELHÄHNE "3 WEGE KOMPAKTHAHN" VOLLER DURCHGANG 120°

▪ ESECUZIONI ▪ EXECUTIONS ▪ EXECUTIONS ▪ BESCHREIBUNG

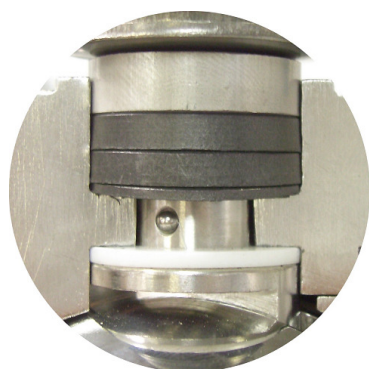

EXECUTION 4 - 12

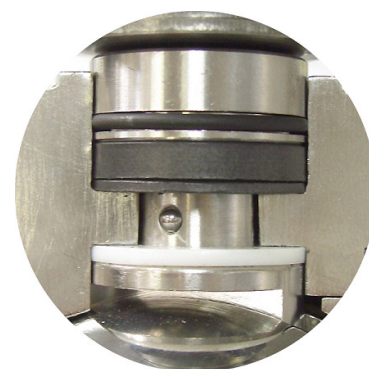
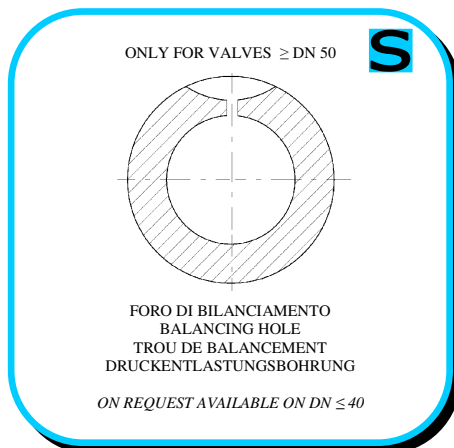

EXECUTION 6 - 16

S STANDARD

O OPTIONAL

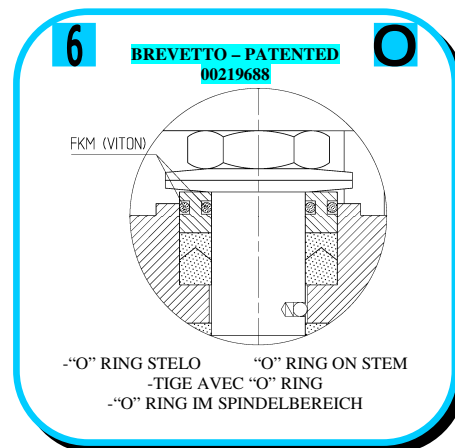
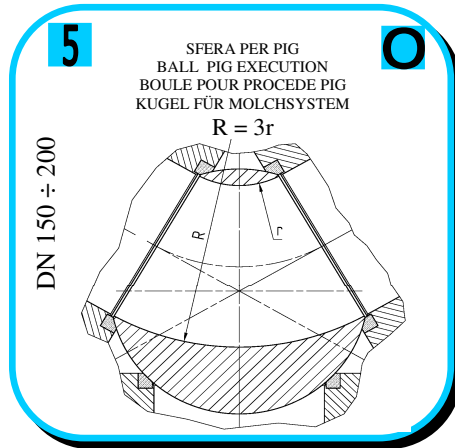
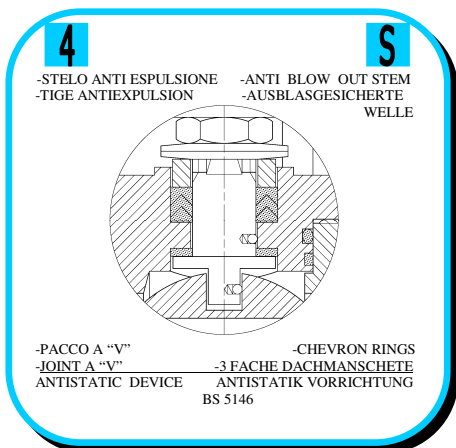
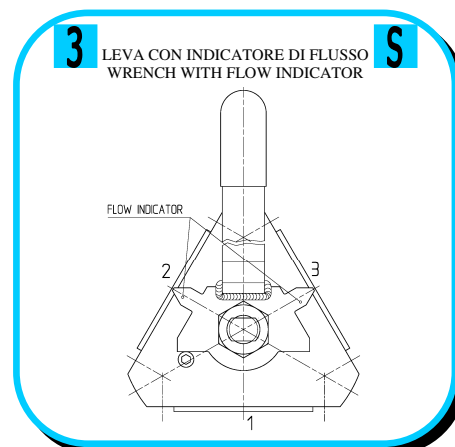
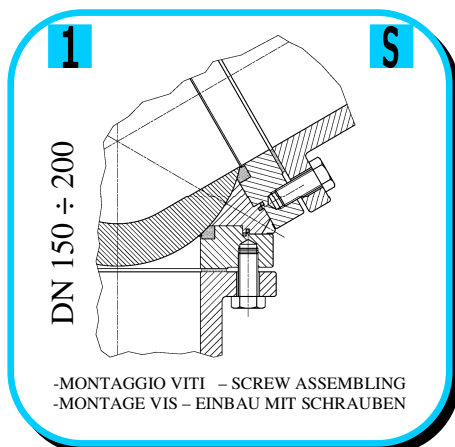
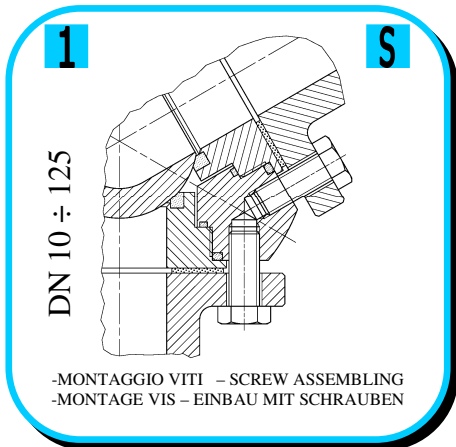

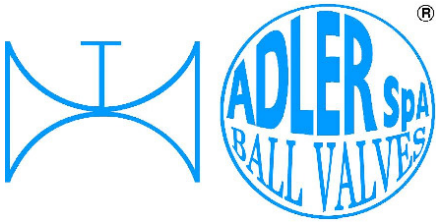

ISO 9001:2008 by L.R.
 PED DIR. 97/23/EC by L.R.
 ATEX DIR. 94/9/EC by B.V.
 FIRE SAFE EXECUTION by L.R.
 ISO 15848 by TÜV
 ANTISTATIC DEVICE by L.R.
 FIRE SAFE TESTED ISO 10497 by L.R.

TYPE
FU4
 PN 10 ÷ 40
 ANSI 150

VALVOLA A SFERA "3 VIE CORPO PIATTO" PASSAGGIO TOTALE 120° ROBINETS A BOISSEAU SPHERIQUE "3 VOIES WAFER" PASSAGE INTEGRAL 120°
 BALL VALVES "3 WAY WAFER" FULL BORE 120° KUGELHÄHNE "3 WEGE KOMPAKTHAHN" VOLLER DURCHGANG 120°

• ESECUZIONI • EXECUTIONS • EXECUTIONS • BESCHREIBUNG

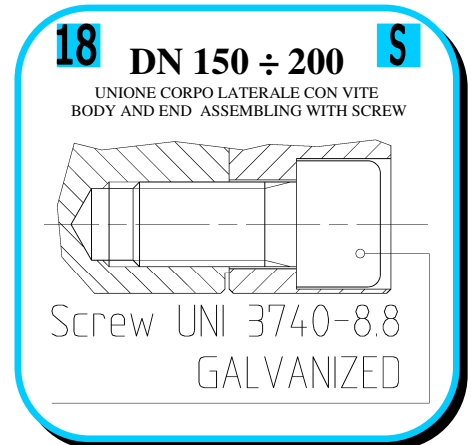
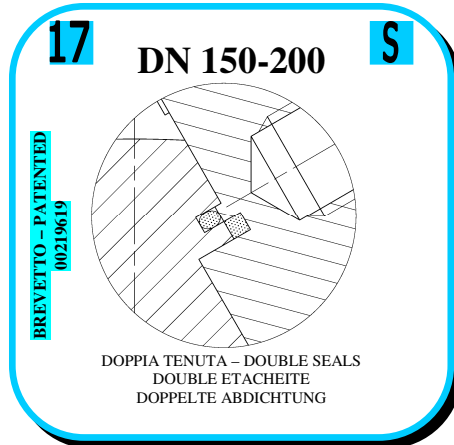
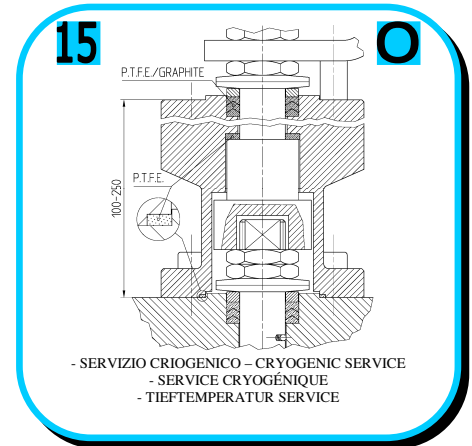
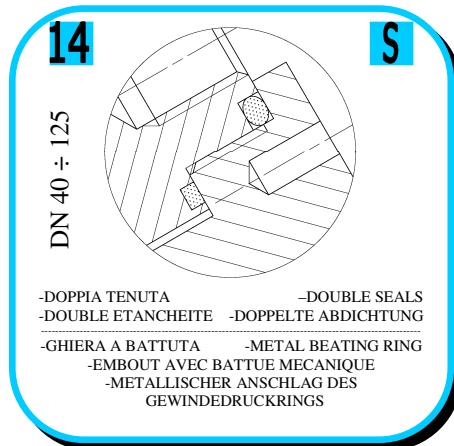
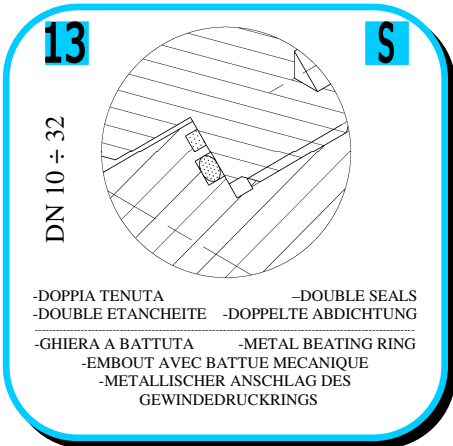
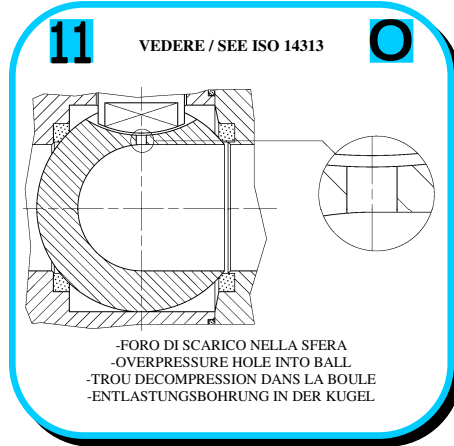
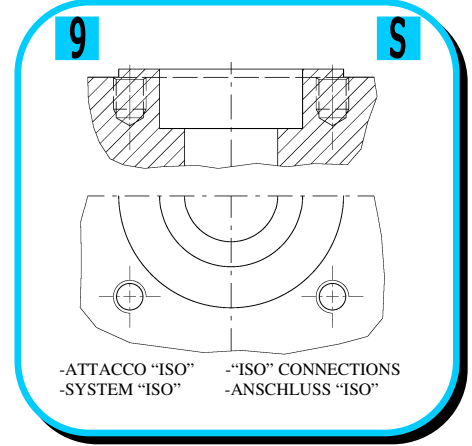
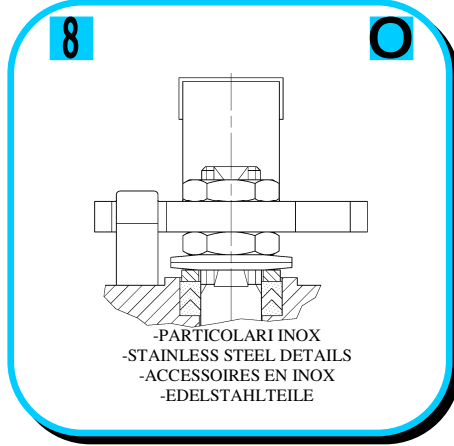
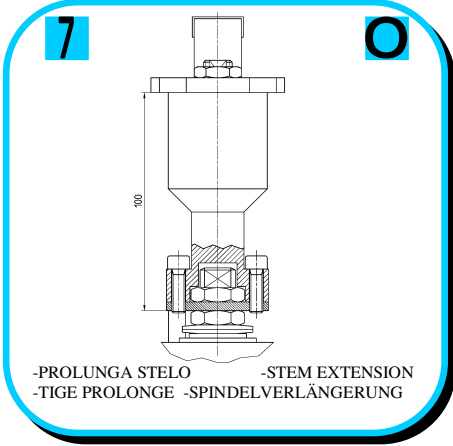

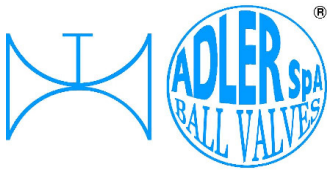

**VITI D'ASSEMBLAGGIO PER FU4
ASSEMBLING SCREWS FOR FU4
VIS D'ASSEMBLAGE POUR FU4
MONTAGESCHRAUBEN FÜR FU4**

**TABLE
08**

N° VITI – DIMENSIONE • N° SCREW – DIMENSIONS • N° VIS- DIMENSIONS • N° SCHRAUBEN – ABMESSUNGEN

EUROPEAN NORM

DN PN	10-15	20	25	32	40	50	65	80	100	125	150	200
10	12 M12 X30	12 M12 X30	12 M12 X30	12 M16 X35	12 M16 X35	12 M16 X40	12 M16 X40	* 24 M16 X40	24 M16 X40	24 M16 X45	24 M20 X45	24 M20 X50
16	12 M12 X30	12 M12 X30	12 M12 X30	12 M16 X35	12 M16 X35	12 M16 X40	12 M16 X40	24 M16 X40	24 M16 X40	24 M16 X45	24 M20 X45	36 M20 X50
25	12 M12 X30	12 M12 X35	12 M12 X35	12 M16 X40	12 M16 X40	12 M16 X40	24 M16 X45	24 M16 X45	24 M20 X50	24 M24 X55	24 M24 X55	36 M24 X60
40	12 M12 X30	12 M12 X35	12 M12 X35	12 M16 X40	12 M16 X40	12 M16 X40	24 M16 X45	24 M16 X45	24 M20 X50	24 M24 X55	24 M24 X55	36 M27 X65

ANSI METRIC

(STANDARD ADLER)

Ø Rating	1/2"	3/4"	1"	1 1/4"	1 1/2"	2"	2 1/2"	3"	4"	5"	6"	8"
150	12 M14 X30	12 M14 X30	12 M14 X30	12 M14 X45	12 M14 X35	12 M16 X40	12 M16 X40	12 M16 X45	24 M16 X45	24 M20 X50	24 M20 X50	24 M20 X50

ANSI B1.1 UNC

(ON REQUEST)

Ø Rating	1/2"	3/4"	1"	1 1/4"	1 1/2"	2"	2 1/2"	3"	4"	5"	6"	8"
150	12 1/2 X 1 1/4	12 1/2 X 1 1/4	12 1/2 X 1 1/4	12 1/2 X 1 1/4	12 1/2 X 1 1/2	12 5/8 X 1 1/2	12 5/8 X 1 3/4	12 5/8 X 1 3/4	24 5/8 X 1 3/4	24 3/4 X 2	24 3/4 X 2	24 3/4 X 2



ADLER SpA – BALL VALVES
20010 S. STEFANO TICINO (MI) ITALY V.le BORLETTI, 14 Tel. +39/02974842.11 FAX +39/0297271698
E-mail: adler@adlerspa.com <http://www.adlerspa.com>

Tab-08/12 RIPRODUZIONE VIETATA - COPYRIGHT